

MODEL 525C52, 655C52, 725C52, 925C52,

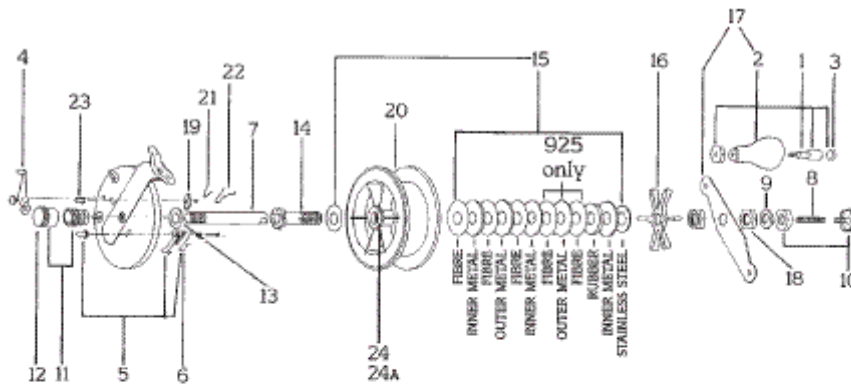

KEY NO.	DESCRIPTION	PART NO.			
		525C52	655C52	725C52	925C52
1	HANDLE SCREW	R4E9	R4E9	R4E9	R4E9
2	HANDLE ASSEMBLY	R4F7	R4F7	R4F7	R4F7
3	FELT PLUG	R4H2	R4H2	R4H2	R4H2
4	DRAG LEVER & RIVET	R5C2	R5C2	R5C2	R5C2
5	RATCHET ASSEMBLY	R5E6	R5E6	R5E6	R5E6
6	RATCHET SPRING	R5F2	R5F2	R5F2	R5F2
7	SPINDLE	R6A12	R6A12	R6A12	R6A12
8	SPINDLE SPRING	R6C5	R6C5	R6C5	R6C5
9	SPINDLE 'D' WASHER	R6D2	R6D2	R6D2	R6D2
10	SPINDLE SCREW	R6E4	R6E4	R6E4	R6E4
11	SPINDLE GREASE CAP & NUT	R6G1	R6G1	R6G1	R6G1
12	GREASE CAP ONLY	R6G2	R6G2	R6G2	R6G2
13	SPINDLE FIBRE WASHER	R6J5	R6J5	R6J5	R6J5
14	DRAG FRICTION TUBE	R7A4	R7A4	R7A4	R7A4
15	DRAG CLUTCH WASHERS (Metal & Fibre)	R7B/C5	R7B/C5	R7B/C6	R7B/C6
16	DRAG STAR ADJUSTING NUT	R7D5	R7D5	R7D5	R7D5
17	DRAG HANDLE PLATE ASSEMBLY	R7E10	R7E11	R7E13	R7E14
18	DRAG HANDLE PLATE LOCK NUT	F7F2	F7F2	F7F2	F7F2
19	DRAG PAWL	R7J2	R7J4	R7J4	R7J4
20	DRAG SPOOL ONLY	R4A	R4A	R4A	R4A
21	DRAG PAWL SPRING	R5G1	R5G3	R5G3	R5G3
22	DRAG LEVER SPRING	R5H1	R5H1	R5H1	R5H1
23	DRAG KNOB & WHEEL	R7K2	R7K2	R7K2	R7K2
24	SILENT DRAG CAM		R7L1	R7L1	R7L1
24A	RATCHET WHEEL	R5B5	R5B5	R5B5	R5B5